

Decebal

Commercial Spaces

CARACTERISTICS

- ▶ **AREA:** Decebal
- ▶ **Usable surface:** 238 sqm
- ▶ **Floor:** P
- ▶ **Showcase:** 27

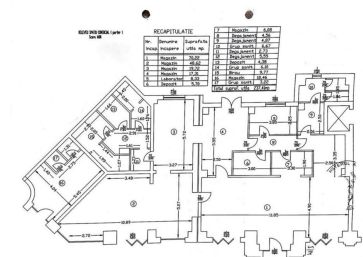

DESCRIPTION

The commercial space is located on Decebal Boulevard, benefiting from commercial and auto traffic. The space is arranged on the ground floor.

Facilities:

- opening at 27 m;
- 3 front entrances;
- access for suppliers;

The space is divided into 2 parts:

- I. SU= 22 sqm - rented until 1 October 2024;
- II. SU= 216 sqm rented to a cafe from 1998 - until 1 October 2028;

1,200,000 EUR

18.94 BITCOIN

397.31 ETHEREUM