

## Galati

### CARACTERISTICS

- ▶ **AREA:** Galati
- ▶ **Built surface:** 3346 sqm
- ▶ **Land Surface:** 2139 sqm
- ▶ **Construction year:** 1980
- ▶ **Maximum height:** P+2 P+3

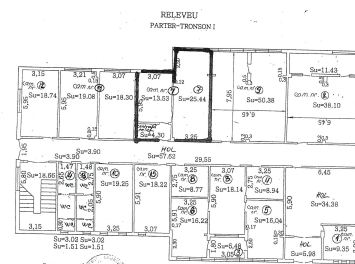

### Layout

Land surface: 2.139 sqm

Total built area (Section I + Section II):  
3,346 sqm

Section I (GF+3F) 1,933 sqm

Section II (GF+2F) 1,413 sqm

Usable area: 2.923 sqm

Arrangement of the building P+3E

Double opening: 55 m at Faleza Dunarii  
Alley

Opening at Portului Street

### DESCRIPTION

The property is located in the Galati Port area with a very beautiful opening and view of the Danube Cliff. The access to the property is very easy due to the double opening, both to the Danube Cliff Alley and to the Portului Street. The real estate is very good for investment being rented in a very large proportion and with good rental potential to 100%. The property has its own elevator and parking spaces. The property is partially rented.

Current rental income: 15.000 Euro /month  
Estimated rental income: 18.000 Euro / month

2,140,000 EUR

22.51 BITCOIN

643.90 ETHEREUM