

## Calea Dorobantilor

### CHARACTERISTICS

- ▶ **AREA:** Calea Dorobantilor
- ▶ **Usable surface:** 846 sqm
- ▶ **Built surface:** 1061 sqm
- ▶ **Maximum height:** D+P+3E+M

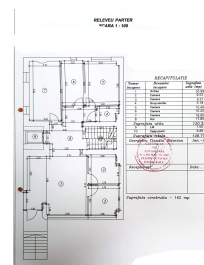
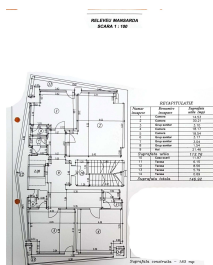

### DESCRIPTION

The office building is situated on Calea Dorobanti, very close to Dorobanti Square, Primaverii neighborhood, at only a few minutes distance from Romana Square and Charles de Gaulle Square.

- the building has elevator;
- underground parking places;
- the space is divided on each floor;
- sanitary groups on each floor;

15,000 EUR + VAT

0.26 BITCOIN + VAT

4.79 ETHEREUM + VAT