

Aviatorilor

CARACTERISTICS

- ▶ **AREA:** Aviatorilor
- ▶ **Usable surface:** 1308 sqm
- ▶ **Floor:** P, Et. 1 Et. 4
- ▶ **Maximum height:** 3S+P+5E

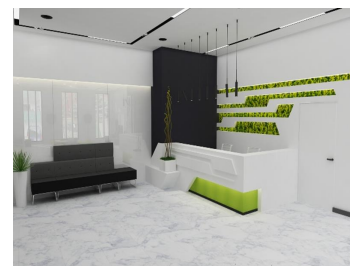

Layout

Ground floor: 357 sqm

1st Floor: 588 sqm;

4th Floor: 363 sqm

Maintenance: 4 Euro/ sqm/ month + VAT

DESCRIPTION

Office spaces for rent situated in a building disposed in Charles de Gaulle area at only a few minutes distance from Victoriei square. The building benefits of a beautiful view to Herastrau Park.

Facilities:

BMS

raised floor;

fire detection system with sprinklers system;

2 elevators for person;

elegant reception;

HVAC - fancoil system

CCTV system

individual power generator

parking places: 125-175 Euro/ place