

## Dimitrie Pompei

### CHARACTERISTICS

- ▶ **AREA:** Dimitrie Pompei
- ▶ **Usable surface:** 2718 sqm
- ▶ **Floor:** P, Et.1
- ▶ **Maximum height:** 2S+P+7E

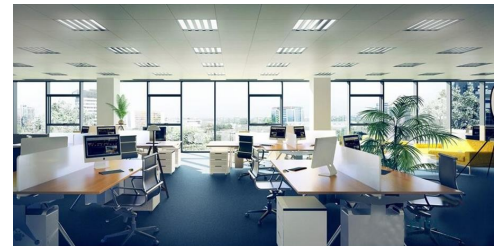
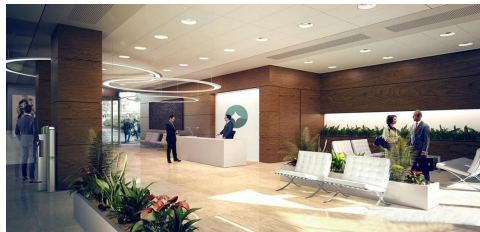

### Layout

2 Office buildings: 2B+GF+4F

1 Office building: 2B+GF+7F

1 Hotel: 2B+GF+11F: 140 rooms

Available areas: 2,543 sqm

Ground floor: 93 sqm and 82 sqm

Rental prices:

Ground floor: 15 Euro/sqm/month+ VAT

1st Floor: 15 Euro/sqm/ month +VAT

Maintenance: 3 Euro/sqm/ month +VAT

### FINISHES/EQUIPMENT

- ▶ **Others:** Fire Protection, Video Surveillance , AC, Heating System, Internet and Voice Connection , TV Cable, Administrare, Garage, Insulated Windows , Elevator

### DESCRIPTION

Office building situated in North side of Bucharest very close to many other business centers. The location allows an easy access to all means of transportation being close to Pipera subway station.

Facilities:

- A class office building;

- open space
- air conditioning system HVAC
- high speed elevator
- smoke/ heat detectors;
- access control system;
- video surveillance and security system;
- fiber optic
- PC and phone network
- Emergency generator for common and essential systems;
- security 24/7
- parking places: 70 Euro +VAT/place/month;

**13.50 EUR sqm + VAT**